

Gemini Twin Fans

Kitchen/Utility

Run & Standby Fans



Features & Benefits

- Suitable for kitchen and utility room applications
- Comes complete with a plug in power pack
- Duty sharing features supplied as standard
- Meets current Building Regulations Approved Document F
- Surface, flush and duct mounting versions are available
- Overrun timer as standard
- Remote PIR's or humidity sensors can be installed

Ultra quiet ventilation

The Vent-Axia Gemini range of run and standby fans offers high performance double inlet forward curve fan motor impellers, typically suitable for high system resistance installation. In the event of failure the standby fan is operated, and visual fan failure indication (via integrated or optional remote indication light) is illuminated. The surface mounting model has a styled cover. For flush or duct mounting the power pack and back plate assembly is located within a galvanised steel casing and fitted with either a PVC cover for flush mounting or a galvanised steel cover for connection to ducts.

The Gemini range has an integrated overrun timer function fitted as standard, enabling versatile operation to **comply with the Building Regulations Approved Document F** for internal rooms and Local Authority specification. The overrun timer can be manually adjusted between 1 and 20 minutes. (Units are factory set with the timer set to approximately 20 minutes).

All models incorporate a basic power pack which includes the motor housing, power on, fan run and fan fail indication light, which allows you to install the back plate at the first fix stage and plug in the power pack when the unit is ready for use. The power pack is pre-wired and incorporates a plug in arrangement for fitting to the back plate.

Installation

The Vent-Axia Gemini range is designed for installation in kitchens and utility rooms. Surface, flush or duct mounting models are available. The units **meet current Building Regulations Approved Document F**.

Models

Gemini Surface

A surface mounted twin fan model with 100mm spigot.

Model Stock Ref
GTF5 457479

Gemini Recessed

A flush mounted twin fan model for recessed applications.

Model Stock Ref
GTF6 457480

Gemini Duct

A twin fan ducted model for in-line applications.

Model Stock Ref
GTFD 457481

Accessories

Remote Indicator

The remote indicator unit provides fan status information at a convenient position.

Stock Ref
180010

Dual sized spigot

Stock Ref
GTFSP

Wall Kit

Stock Ref
254102 (White)
254100 (Brown)

Performance

Model	Extract Performance - FID		Speed RPM	Max Watts	Max Amps
	m ³ /h	Sound dB(A) @ 3m			
Surface	216	43	1370	57	0.19
Recessed	205	44	1370	57	0.19
Duct	195	46	1370	57	0.19

Dimensions (mm)

	A	B	C	D	EØ	F	G
Surface	347	170	224	69	99	35	
Recessed	385	233	366	255	98	230	35
Duct	366	233	230	36	98		

Gemini Surface

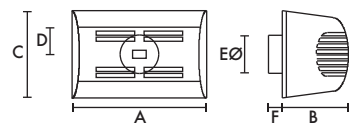

Gemini Recessed

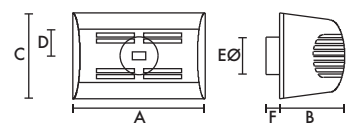

Gemini Duct

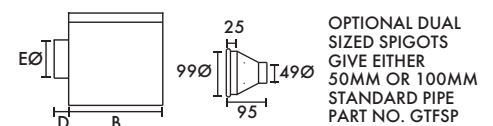
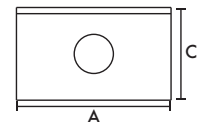

OPTIONAL DUAL SIZED SPIGOTS GIVE EITHER 50MM OR 100MM STANDARD PIPE PART NO. GTFSP